

Hotel suggestions ABAOMS Leeds 2025

Cloth Hall Court. LS1 2HA

<https://conferencesandevents.leeds.ac.uk/cloth-hall-court/>

Resides in the city centre-on Quebec Street, 2 minutes' walk from Leeds train station, a 15-minute walk from the coach station and 8.5 miles from Leeds Bradford Airport and located close to several car parks.

Their basement has space to secure up to 7 cycles.

Coming from Leeds Bradford airport, options are to take the Flyer A1 Bus Service from Leeds Bradford Airport which drops off very close to the venue and city centre hotels. (single is £4.00 and a return is £6.00).

Buses run approximately every 30 minutes from Stand 1 at Leeds Bradford Airport.

Alternatively, a taxi will cost between £35-£40 one way.

There are many hotel options – below are a few of the closest at a range of prices direct from their websites at the time of producing this document.

The Queen's Hotel Leeds

<https://www.thequeensleeds.co.uk>



Located next door to the train station and a 2-minute walk to the conference venue.

Advanced purchase rate for 1 night (Thursday) £150.30 Room only

Advanced purchase rate for 1 night B&B (Thursday) £163.80

Long stay carpark available at the train station- please contact the hotel directly.

Hyatt House Leeds

<https://www.hyatt.com/hyatt-place/en-US/lbازل-hyatt-place-leeds/gallery>

<https://maps.google.com/?q=Hyatt%20Place%20Leeds>

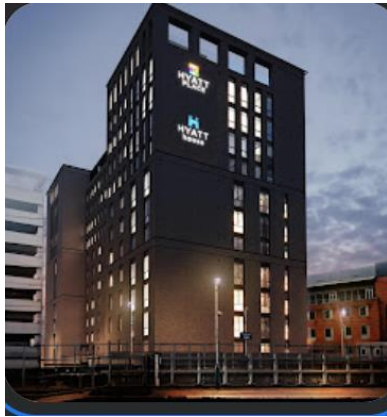

Located a 3 minute-walk from the train station, a 5-minute walk to the conference venue.

Advanced purchase – King bed (Thursday) Room only £128.00

Advanced purchase – King bed (Thursday) B&B £143.95

Q -Park- car park next door - £35% discount on parking via the hotel.

Marriot Hotel Leeds

<https://www.marriott.com/en-gb/hotels/lbadt-leeds-marriott-hotel/overview/>



Located a 5-minute walk from the train station and a 6 minute to conference venue.

Non- refundable advanced purchase (Thursday) Room only- £108.00

Non- refundable advanced purchase (Thursday) B&B- £118.00

Discounted parking in the Trinity car park (50% off if you register your car at the hotel reception tablet).

Radisson Blu Hotel, Leeds City centre

<https://www.radissonhotels.com/en-us/hotels/radisson-blu-leeds>



A 5-minute walk from the train station and a 3-minute walk to the conference venue.

Advanced purchase -Queen bed (Thursday) Room only –£106.20

Advanced purchase –Queen bed (Thursday) B&B non-refundable £121.50

The closest parking available is at Q-Park The Light, located at LS2 8BD. As a guest or visitor at Radisson Blu, you are entitled to a 35% discount—this must be pre-booked prior to arrival. Book for the entire duration of your stay and use promotional code RADBLUTL35 using the following link to secure. Book parking now on <https://www.q-park.co.uk/en-gb/cities/leeds/the-light/>

Quebecs Hotel Leeds

<https://quebecshotel.co.uk/home/>



Situated directly opposite the conference venue and 300 metres from the train station. Quebecs is a listed luxury 4-star hotel and the only independently owned luxury hotel in central Leeds.

Deluxe room- (Thursday) Room only –£149.00

Deluxe room- (Thursday) B& B –£168.95

Car parking- the seven spaces available are allocated on a first come first served basis at a charge of £20 per night. Additional parking is available to Quebecs guests at Q-park sovereign square (LS1 4AG) 24/7 at a discounted rate. To qualify for the discount, guests need to pre book the parking by following the below link and calling the hotel for the discount code. <https://www.q-park.co.uk/en-gb/cities/leeds/sovereign-square/>

Doubletree by Hilton

<https://www.hilton.com/en/hotels/lbaccdi-doubletree-leeds-city-centre/>



Located a 3-minute walk to Leeds train station. A 10-minute walk to the conference venue.

Advanced purchase – Queen bed (Thursday) Room only £123.00

Advanced purchase – Queen bed (Thursday) B&B £135.00

On-site parking: The hotel offers self-parking for £21.95 per day. It is limited and operates on a first-come, first-served basis.

Hotel Indigo Leeds

<https://www.ihg.com/hotelindigo/hotels/gb/en/leeds/lbalb/hoteldetail>



A 9-minute walk to the conference venue, an 8-minute walk to Leeds train station.

‘Cosy double’ non-refundable Thursday (Room only) £117.00

‘Cosy double’ non-refundable Thursday (B&B) £127.00

Premier Inn Leeds City centre (Whitehall Rd) hotel

https://www.premierinn.com/gb/en/hotels/england/west-yorkshire/leeds/leeds-city-centre-whitehall-road.html?cid=GLBC_LEEWHI



A 5-minute walk to the conference venue, a 4-minute walk to Leeds train station.

Standard double non-refundable Thursday (Room only) £90.00

There is no on-site parking available at this hotel. Off-site chargeable parking is available at NCP (Wellington Street, Leeds, LS1 4AJ). Open 24 hours and a 10-minute walk from the hotel priced at £16.95 per 24 hours.

Discovery Inn, Bishopgate street

<https://www.discoveryinn-leeds.co.uk/>



Located a 3-minute walk from the train station and a 4-minute walk to the conference venue.

Single room non-refundable (Thursday) Room only £55.44.

Single room advanced booking (Thursday) B&B £62.44

Guests of the Discovery Inn can enjoy exclusive savings on parking at **Q-Park Sovereign Square**, located just a short walk away at LS1 4AG. You can get a discount code from the hotel reception, or prebooking online. Keep in mind that according to one review, pre-booking is necessary to get the discount. Also, note that the parking spaces at Q-Park Sovereign Square have been described as “really difficult to get into spaces”.

Please do look at hotel reviews before booking your accommodation to ensure you book the right place for you.